

ALLDAY
& MILLER



Botwell Common Road, Hayes, UB3 1JA
£200,000

1 1 1 C



Botwell Common Road, Hayes, UB3 1JA

£200,000

- One Bedroom Apartment
- Parking
- Potential Yield of 7.5%
- Easy Reach To An Elizabeth Line Station
- Second Floor
- Chain Free
- Close To Hayes Town Centre
- Leasehold

Description

This property offers an incredible opportunity for first time buyers looking to settle in a comfortable, convenient, and welcoming home.

Comprising of a spacious reception / dining area which integrates with a fitted kitchen creating an open, inviting environment perfect for everyday living. A generously sized double bedroom providing a peaceful retreat for rest and relaxation, completing this charming home is a bathroom.

Situation

Bowtell Common Road is a prime location in the heart of Hayes. Hayes & Harlington station just a short minute drive away with the Elizabeth line making the journey into Central London a breeze, along with the bus station with several routes to local amenities. Hayes town centre with its variety of local shops, cafes, takeaways and coffee shops. The area is also served by a number of highly regarded schools including Lake Farm Park Academy and Rosedale Collage secondary school.



Floor Plans

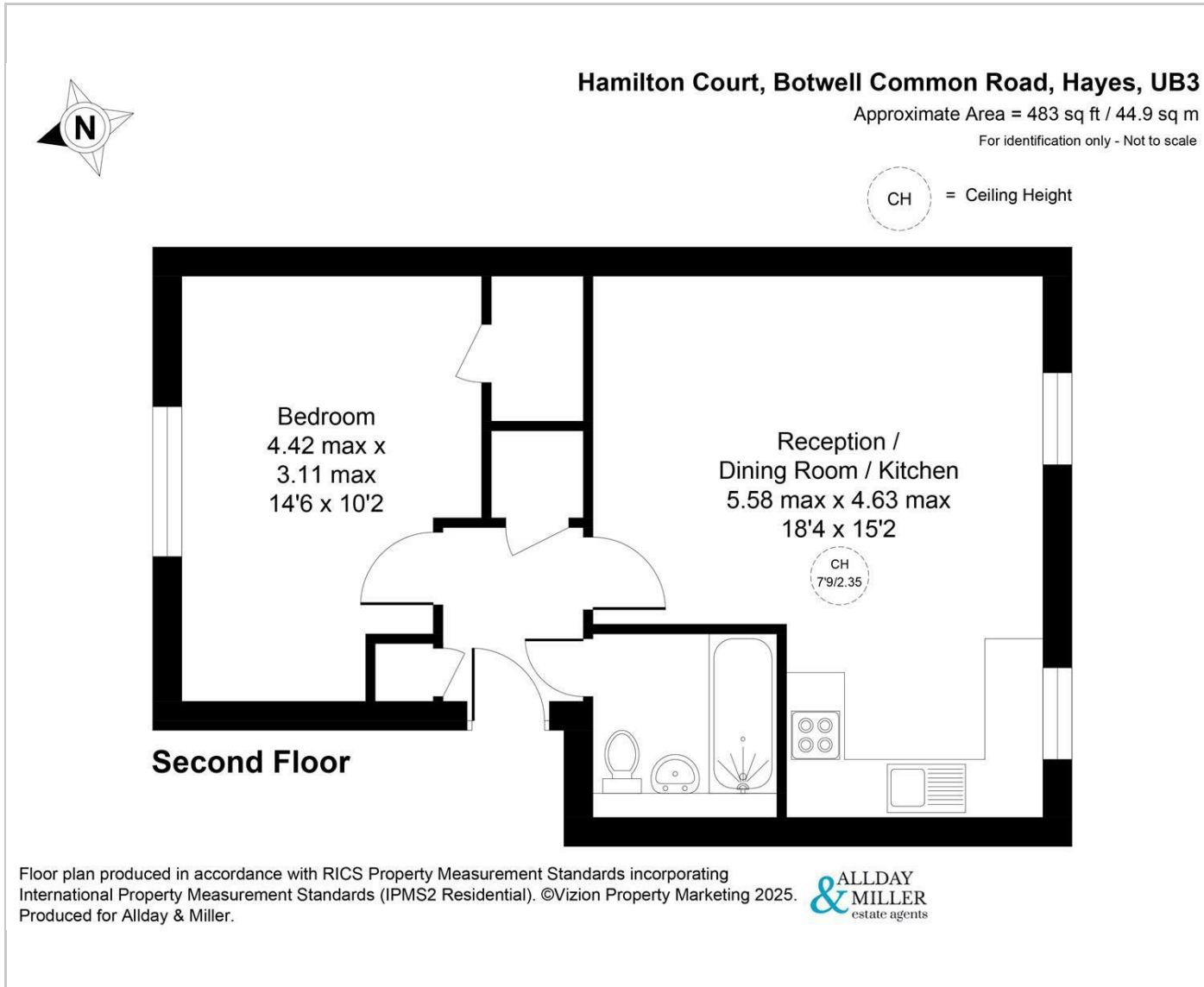

Area Map

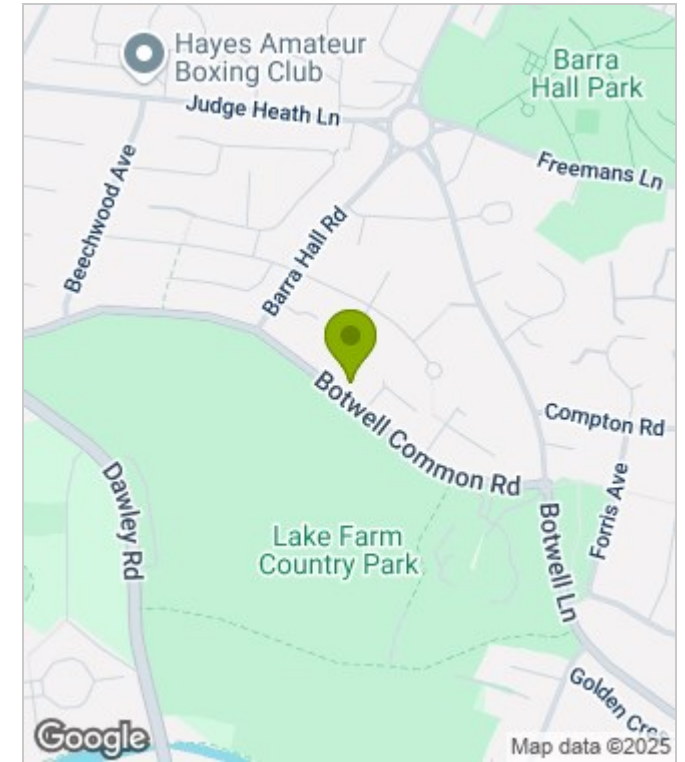

Energy Performance Graph

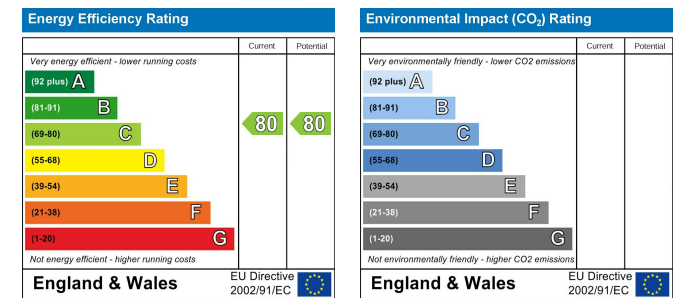

These particulars, whilst believed to be accurate are set out as a general outline only for guidance and do not constitute any part of an offer or contract. Intending purchasers should not rely on them as statements of representation of fact, but must satisfy themselves by inspection or otherwise as to their accuracy. No person in this firm's employment has the authority to make or give any representation or warranty in respect of the property.